

M1

Modello / Model
SMALL / NPT

Materiale / Material
Aisi 316

Tenuta / Seal
FPM

DN
8 – 15

PN
16



Caratteristiche tecniche / Construction features

- **Adatta ad utilizzo con aria compressa o vuoto in applicazioni non gravose** / For use with compressed air or vacuum in low impact applications
- **Otturatore: acciaio inossidabile Aisi 316 con saldatura rinforzata tra perno e disco** / Flow control disc: stainless steel Aisi 316 with reinforced welding between guiding pin and disc
- **Temperatura di esercizio** / Working temperature
-20°C – +150°C

- **Filettatura** / Thread
NPT
- **Certificazioni** / Approvals
 NSF/ANSI/CAN 61 & 372

Dimensioni e pesi / Dimensions and weights

Codice Code	Misura Size	DN	PN	Peso in gr. Weight in gr.	KV m ³ /h	Dimensioni in mm Dimensions in mm			
						A	B	C	D
900104NPTR	1/4"	08	16	140	2,5	20	56	32	1/4" F
900111NPTR	3/8"	10	16	125	3,2	20	56	32	3/8" F
900118NPTR	1/2"	15	16	105	6,0	25	56	32	1/2" F

M1

Modello / Model
SMALL / TYPE EA

Materiale / Material
Aisi 304

Tenuta / Seal
FPM

DN
15

PN
16



Caratteristiche tecniche / Construction features

- **Versione antinquinamento controllabile** / Antipollution checkable version
- **Conforme a** / In conformity with
UNI EN 1717 (tipo / type EA)
- **Foro di ispezione 1/8" gas maschio con tappo su lato aspirazione** / 1/8" male inspection hole with cap on suction side
- **Conessioni filettate femmina secondo** / Threaded ends female according to
UNI ISO 228/1
- **Temperatura di esercizio** / Working temperature
-20°C – +150°C

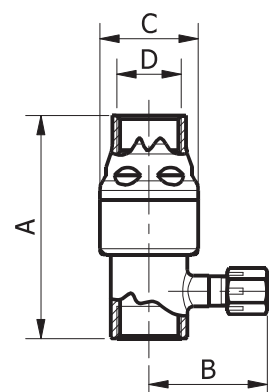

Dimensioni e pesi / Dimensions and weights

Codice Code	Misura Size	DN	PN	Peso in gr. Weight in gr.	KV m ³ /h	Dimensioni in mm Dimensions in mm			
						A	B	C	D
900116T	1/2"	15	16	130	6,0	71	40	32	1/2" F